

SECTOR - 69

S.A.S. NAGAR  
SECTOR - 78

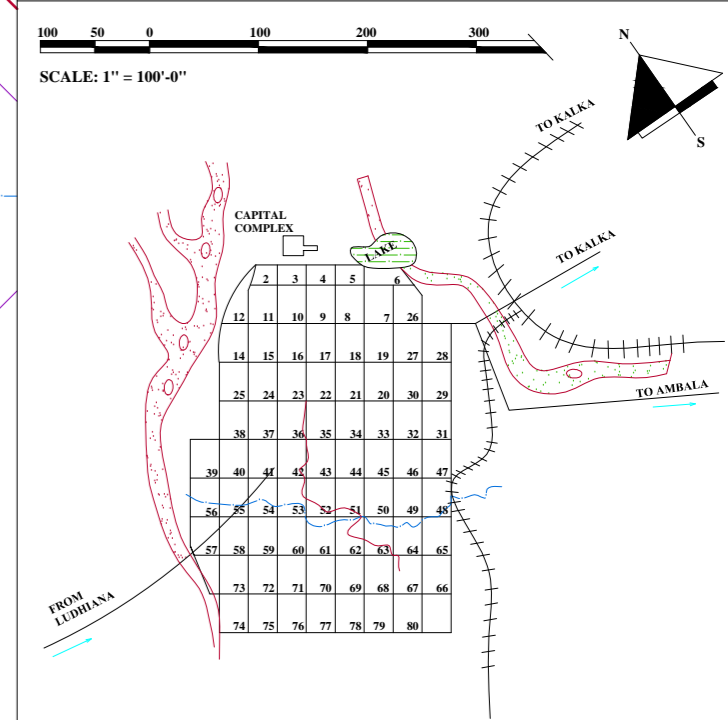

INSET PLAN

LEGEND:-

- Residential
- Multistoried flats
- Existing village sohana
- Commercial
- Educational
- Medical
- Public buildings
- Reserved
- Roads & open spaces
- Bus terminus
- T.W.
- Pavement

DETAIL OF AREAS:-

| Area   | AREA IN ACS. | %AGE   |
|--|--------------|--------|
| Gross area of sector 78 (including vill. Sohana & gurudawara singh shahedan) | 356.99       |        |
| Area under peripheral roads  | 23.20        |        |
| Area of institutions exempted  | 7.34         |        |
| Gurudawara Singh Shahedan  | 3.39         | 153.51 |
| Rattan Professional Edu. Society   | 2.82         |        |
| B.S.H. Arya School   | 116.76       |        |
| Area under village abadi   | 203.48       |        |
| Net planned area   |              |        |
| Area under residential including m.s. flats                                  | 53.45        | 26.27% |
| Area under commercial  | 28.52        | 13.92% |
| Area under educational   | 6.56         | 3.22%  |
| Area under public building   | 13.15        | 6.46%  |
| Area under bus stand   | 19.39        | 9.53%  |
| Area under vet. hospital   | 1.42         | 0.70%  |
| Area under religious   | 0.04         | 0.02%  |
| Area under reserved  | 2.04         | 1.00%  |
| Area under l.w.  | 0.29         | 0.14%  |
| Area under roads & open spaces   | 78.82        | 38.74% |
|  | 203.48       | 100 %  |

SCHEDULED OF PLOTS:-

DETAIL OF RADII OF ROADS JUNCTION:-

| JUNCTION BETWEEN ROAD | RADIUS                 |
|-----------------------|------------------------|
| 200 150               | As per junction detail |
| 200 100               | As per junction detail |
| 200 80                | As per junction detail |
| 150 100               | As per junction detail |
| 150 80                | As per junction detail |
| 100 100               | 35'-0"                 |
| 100 80                | 35'-0"                 |
| 100 60                | 30'-0"                 |
| 100 40                | 25'-0"                 |
| 80 80                 | 30'-0"                 |
| 80 60                 | 30'-0"                 |
| 80 40                 | 25'-0"                 |
| 60 60                 | 25'-0"                 |
| 60 40                 | 20'-0"                 |
| 40 40                 | 15'-0"                 |
| 40 24                 | 15'-0"                 |

- All corner plots marked (p) shall have 5'-0" radius.
- Boundary walls of public building, educational, institutions, m.s.flats & reserved pocket abutting the road junction shall have 15'-0" radii.

NOTES:-

- All measurements are to be exact & should be checked at site.
- All dimensions are to be taken from the centre line of carriage way which are shown in dash & dots.
- Detail of commercial pockets shall be supplied later.
- The layout cum demarcation plan has been approved by chief town planner vide encl. no. 1668-c.p. (ph.) /sc-114 dated 28.7.2004 and in p & d committee meeting held on dt. 25.04.
- Tube well sites 7 nos. has been incorporated as per plans supplied by divisional engineer (ph-i) vide his letter no. d.e.(ph-i)/07/3469 dated 12.6.07. l.w. site area 0.09 acs. near junction sector 78-79 near reserved area has been merged in reserved pocket total area 0.70 + 0.09 = 0.79 acs. as per detailed in rpt meeting dated:-
- Site for the mohali co-op house bldg. society ltd. allotted as per gmada's letter no. (gmada) / 2011/5861 dt. 25.04.2011.
- Site for the panjab school education board employees co-op house bldg. society allotted as per gmada's letter gmada (policy) /2011/5865 dt. 25.04.2011.
- Site for fire brigade station has been allotted as per gmada's letter no. gmada (policy) /2011/5900 dt. 27.04.2011 in lieu of veterinary hospital.
- Site for church has been allotted vide gmada encl. no. gmada (c.a./2012/4109 dated 13.2.2012
- Planning of a marla size plots for outstems of sector-76 to 80 (near B.S.H. Arya School) has been approved by chief town planner panjab vide memo no. 629 sc-114 vol.-3 dt. 31-01-2013

NOTE:- THIS DIGITIZED DRAWING IS BASED ON THE ORIGINAL DRAWING OF THE CONCERNED DEPARTMENT. IN CASE OF ANY DISCREPANCY THE DETAILS IN THE ORIGINAL DRAWING SHALL PREVAIL UPON.

LAYOUT CUM DEMARCATION PLAN

OFFICE OF THE DIVISIONAL TOWN PLANNER  
S.A.S NAGAR

DRG. NO: D.T.P.(S.A.S. nagar) /1688/2003 DATED: 14.7.2003

TRACED BY: - Sd - CHECKED BY: - Sd -

|                            |                    |                     |                    |
|----------------------------|--------------------|---------------------|--------------------|
| - Sd -<br>Planning Officer | - Sd -             | - Sd -              | - Sd -             |
| Asst. Town Planner         | dist. Town Planner | Senior Town Planner | Chief Town Planner |

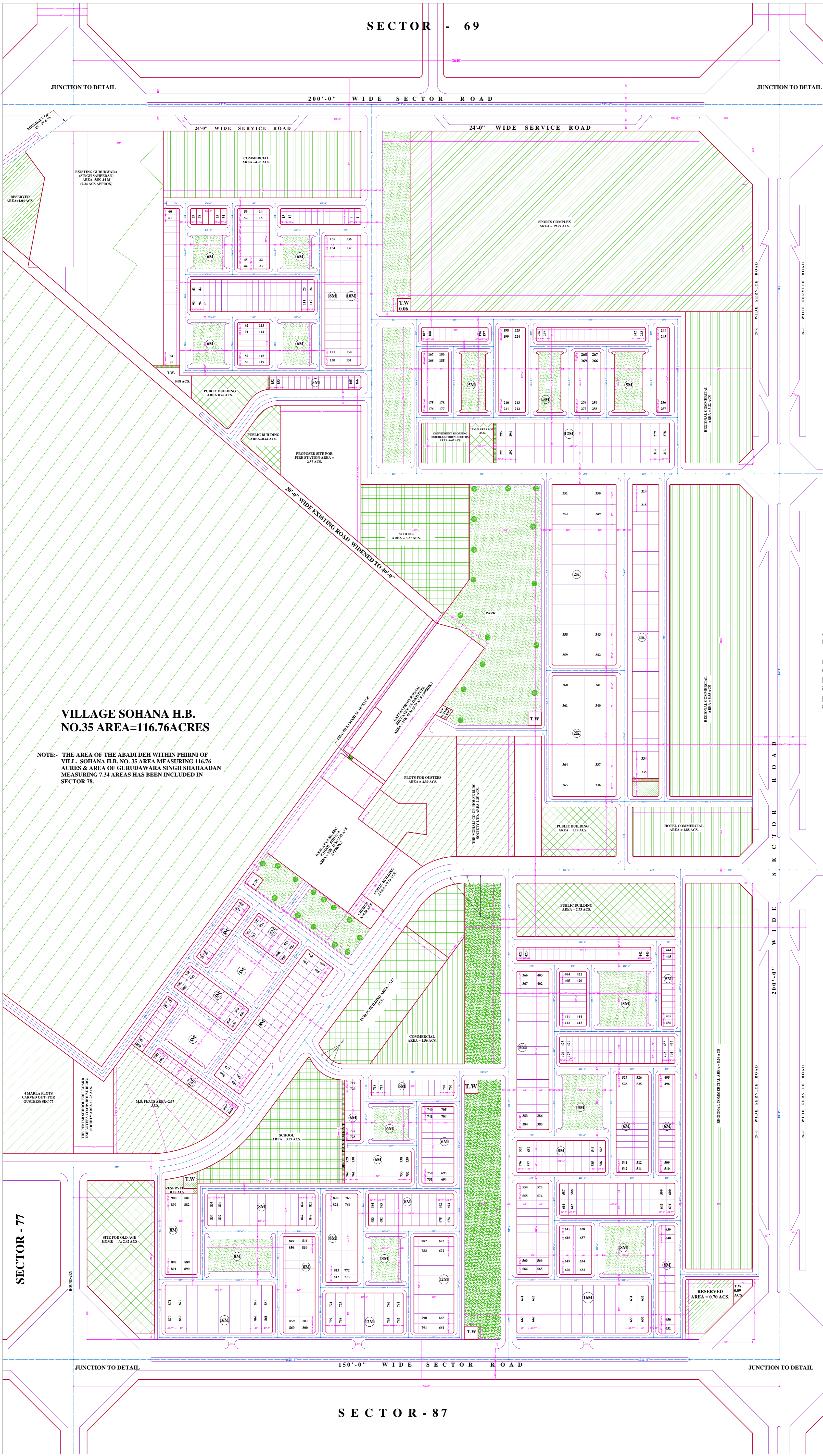

VILLAGE SOHANA H.B.  
NO.35 AREA=116.76ACRES

NOTE:- THE AREA OF THE ABADI DEH WITHIN PHIRMI OF VILL. SOHANA H.B. NO. 35 AREA MEASURING 116.76 ACRES & AREA OF GURUDAWARA SINGH SHAHADAN MEASURING 7.34 AREAS HAS BEEN INCLUDED IN SECTOR 78.

SECTOR - 79

SECTOR - 87