

**S.A.S. NAGAR  
SECTOR-66**

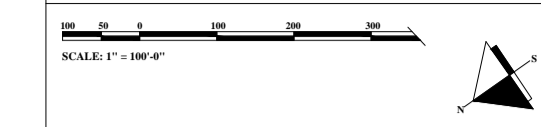

**INSET PLAN**

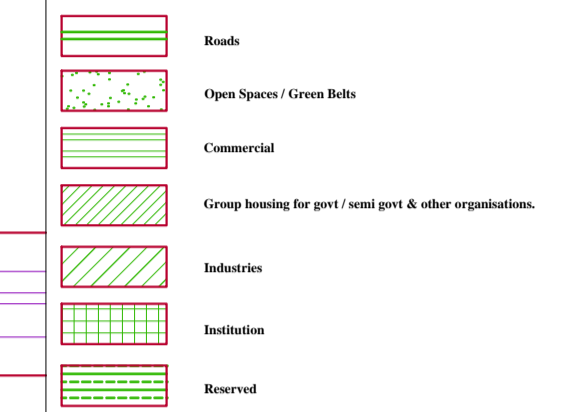

**DETAIL OF AREA**

|                            |             |             |
|----------------------------|-------------|-------------|
| Total area of sector       | 4425 X 2500 | 250.02 ACS. |
| No area under scheme       |             | 150.00 ACS. |
| Area under group housing   |             | 64.43 ACS.  |
| Area under public building |             | 4.80 ACS.   |
| Area under commercial      |             | 8.82 ACS.   |
| Area under roads           |             | 12.29 ACS.  |
| Area under open space      |             | 4.00 ACS.   |
| Reserved                   |             | 14.49 ACS.  |

**NOTES:**

- Four tube well sites (marked 2F-25F) have been marked as per divisional engineer P.D.A. approved dated 26.06.06.
- This drawing is based on the survey supplied by district town planner p.d.a.s.s. nagar dt. 21.3.07.
- This is based on the existing focal point Dig No. P.S.E.C. / D.T.P. / 99 / 19-A dated 28.09.06 revised dt. 24.10.09.
- All the measurements shown on the plan should be cross checked at the time of construction, if any discrepancy be found should be brought to the notice of D.T.P. S.A.S. Nagar.
- Final drawing as approved by P.D.A. committee meeting held on dated 1.5.07.
- Site plan (marked 2F-25F) shown in large reserved as per the sewerage treatment plant is shown.
- Area marked as group housing for Govt / Semi Govt. & other organisations has been changed as per sketch supplied by P.D.A. site letter no. P.D.A. TFW 99/06 dated 13.08.06.
- This drawing has been traced from Dig. No. D.T.P. S.A.S. Nagar / 1196 / 07 dt. 21.3.07.
- The site earlier earmarked for Primary School (200' x 200') has been changed to middle / high school as per P.D.A.'s Letter No. 4218 dated 7.06.06 & its meeting minutes dated 14.06.06.
- Site for Punjab Agri Foodgrains Corporation Ltd. has been allotted vide GMADA Encls. No. GMADA (Policy) / 2007 / 1124-25 dt. 27 / 8 / 07.
- Detail of L.L.G. M.C.C. Housing has been incorporated as per P.D.A.'s Dig No. 37 Job No M-66 dated 21.08.06.
- For detail of commercial shopping (A-40 ACS) refer P.D.A.'s Dig No. 1-36 No. C-56 dated 4-12-06, supplied vide P.D.A.'s Letter No. P.D.A.'s T.P.W.06/0612 OLT 24-12-06.
- Site for Telecom Communication has been incorporated as per P.D.A.'s Dig No. 09 Job No M-66 dated 21.8.2006 supplied vide P.D.A.'s Letter No. P.D.A.'s T.P.W.06 / 1074 dated 26-2-2009.
- Site of M.S. Post for Police Deptt. incorporated as per Enforcement vide P.D.A. T.P.W.06/1087 DATED 21-11-2011.
- Site for Yashwanthi Maternity Centre (Maidan) has been marked as per P.D.A. Letter No. P.D.A. T.P.W.06/1017 dated 8/10/06.
- Site for legal services authority has been removed from lay out as per GMADA's Letter No. 2011 / 128 dated 1.2.2011.
- Reserved site along with sewerage treatment plant (Area 25.00 acs. approx.) has been approved for the L.L.G. E.C.S. houses in the 11th meeting of the Punjab Regional and town planning and development board held on 24th sep. 2008 vide item no.7.
- Site for Garudwara has been allotted vide GMADA Encls. No. GMADA (Policy) / 2007 / 1048 dt. 27/8/06.
- Site for Shri Shakti Maidan has been allotted vide GMADA Encls. No. GMADA Encls. / 2007 / 1088 dated 6. 2. 12.
- As per divisional letter in the 39th E.P.C. meeting, agenda item no. 39/37, held on 21.03.06, the site of Shri Shakti Maidan has been revised accordingly and adjoining to marking better sites have been converted into one as such proposed as Govt. dispensary.

**DETAIL OF HOUSES**

| SERIAL              | CATEGORY | SIZE OF PLOTS | DESIGN | NO. OF HOUSES |
|---------------------|----------|---------------|--------|---------------|
| 1.                  | M.S.C.   | 65'0" X 30'0" | 107    | 1,123         |
| 2.                  | L.L.G.   | 52'0" X 30'0" | 124    | 1             |
| TOTAL NO. OF HOUSES |          |               |        | 1100          |

**NOTE:**  
THIS DIGITIZED DRAWING IS BASED ON THE ORIGINAL DRAWING OF THE CONCERNED DEPARTMENT. IN CASE OF ANY DISCREPANCY THE DETAILS IN THE ORIGINAL DRAWING SHALL PREVAIL UPON.

**LAYOUT PLAN OF SECTOR - 66**

**OFFICE OF THE DIVISIONAL TOWN PLANNER  
S.A.S. NAGAR**

DRG. NO: (D.T.P.S.A.S. NAGAR)1196/99 DATED: 21.3.07

TRACED BY: Sumon Gupta CHECKED BY: - Sd-

|                    |                    |                    |                    |
|--------------------|--------------------|--------------------|--------------------|
| - Sd-              | - Sd-              | - Sd-              | - Sd-              |
| Planning Officer   | Asst. Town Planner | Asst. Town Planner | Asst. Town Planner |
| - Sd-              | - Sd-              | - Sd-              | - Sd-              |
| Asst. Town Planner | Asst. Town Planner | Asst. Town Planner | Asst. Town Planner |

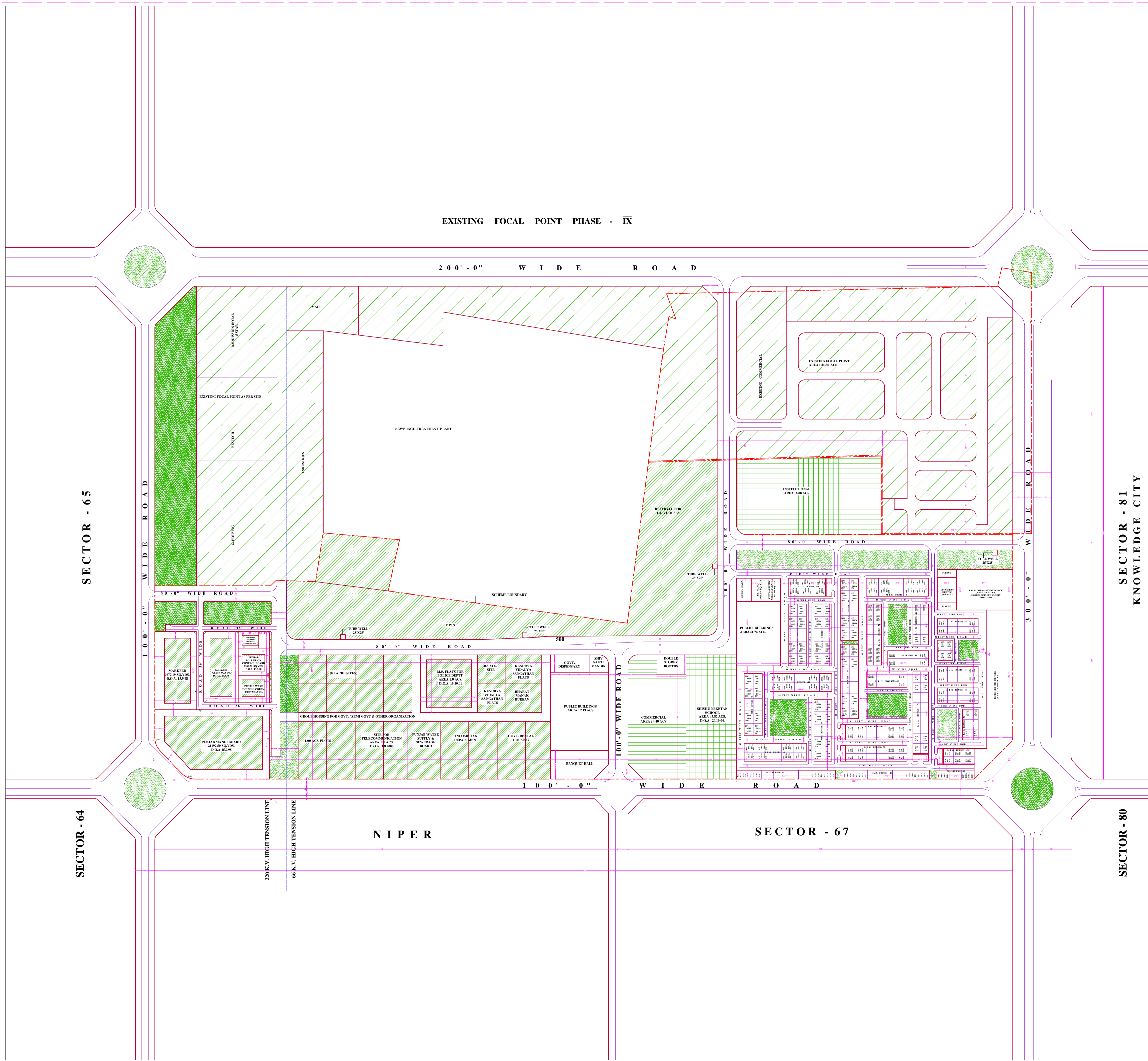

**EXISTING FOCAL POINT PHASE - IX**

**200' - 0" W I D E R O A D**

**SECTOR - 65**

**SECTOR - 81  
KNOWLEDGE CITY**

**SECTOR - 64**

**NIPER**

**SECTOR - 67**

**SECTOR - 80**

**220 K.V. HIGH TENSION LINE**

**66 K.V. HIGH TENSION LINE**