

PROPOSED PLANS FOR  
**SHIVALIK ENCLAVE EXT. I**  
 RESIDENTIAL COLONY AT  
 VILL. SAUTI MAZRA  
 TEH. KHARAR, DIST. ROPAR.

PROMOTERS:  
 M/S SHIVALIK DEVELOPERS & PROMOTERS  
 DEBUMAZRA, CHADIGARH-KHARAR ROAD  
 KHARAR.

AREA DETAIL  
 1. SCHEME BOUNDARY  
 2. TOTAL AREA OF THE SCHEME = 41200.5 B.Y.D.  
 = 8.51 ACRES (83.44 HECTARE)  
 3. AREA UNDER RESIDENTIAL PLOTS

Issued Under Punjab Government & Property Act, 1907, Section 15.3  
 License No. 2001/86  
 Valid upto 27/12/2001  
 Chief Administrator  
 PUDA, CHADIGARH

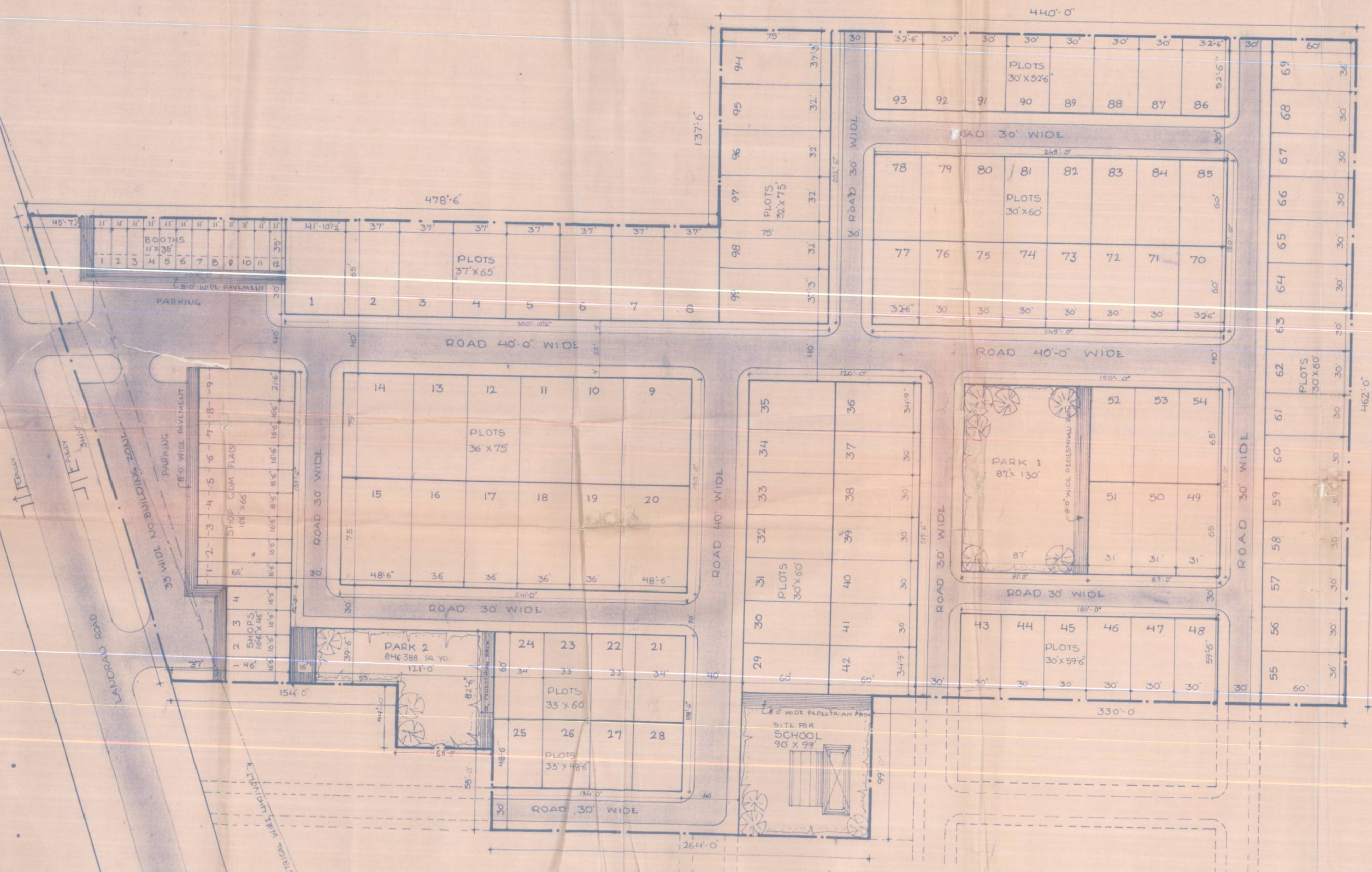

S.NO.	PLOT NO.	NO OF PLOTS	AREA IN SQ. YDS.	TOTAL AREA IN SQ. YDS.	IN ACRES	AREA AS % OF TOTAL
1	1	1	302.430	302.430		
2	2 TO 8	7	267.122	1870.554		
3	9,14,16,20	4	404.166	1616.664		
4	10 TO 13, 16 TO 19	8	300.000	2400.000		
5	21, 24	2	236.666	453.333		
6	22, 23	2	220.000	440.000		
7	25, 26	2	183.222	366.444		
8	26, 27	2	177.833	355.666		
9	29, 35, 36, 42	4	231.666	926.664		
10	30 TO 34, 37 TO 41	10	200.000	2000.000		
11	43 TO 48	6	198.333	1189.998		
12	49 TO 54	6	223.888	1343.338		
13	55, 59	2	240.000	480.000		
14	56 TO 68	13	200.000	2600.000		
15	70, 77, 78, 85	4	216.666	866.664		
16	71 TO 76, 79 TO 84	12	200.000	2400.000		
17	85, 93	2	175.000	375.000		
18	87 TO 92	6	310.416	1862.496		
19	94, 99	2	310.416	620.832		
20	95 TO 98	4	766.666	3066.664		
				22728.4106		55.17%
4.	COMMERCIAL					
1.	SHOP 1 TO 4	4	84.333	337.332		
2.	SHOP CUM FLAT					
1.	1 TO 2	2	131.000	262.000		
9		1	157.666	157.666		
3.	BOOTH 1 TO 11	12	41.777	501.324		
				1876.322		4.54%
TOTAL SALEABLE AREA =				24704.728	510	59.35%
4.	AREA UNDER SCHOOL	1	990.000	990.000	0.20	
5.	AREA UNDER PARKS					
1.	PARK 1		1256.666	1256.666		
2.	PARK 2		846.388	846.388		
TOTAL AREA UNDER PARKS =				2103.054		5.10%
TOTAL AREA UNDER PARKS, PAVEMENTS & PARKINGS =				13402.718	278	31.95%
TOTAL SALEABLE AREA AS % OF TOTAL AREA =				59.96%		
UNDEVELOPED AREA AS % OF TOTAL AREA =				40.04%		

TITLE  
 LAY OUT CUM DEMARICATION PLAN

SCALE: 1" = 40'-0"

OWNER  
 For Shivalik Developers & Promoters

ARCHITECT  
 K. Dhany  
 KRISHAN DHAN  
 ARCHITECT  
 CA/41/123

DATE: 18-05-2001  
 ORG NO. DC/SE-V/11/02  
 DEALT BY: ALLIA  
 CHKD BY: Rajinder

**DHAM CONSULTANTS**  
 ARCHITECTS, PLANNERS & INTERIOR  
 DESIGNERS, STRUCTURAL ENGINEERS &  
 LANDSCAPERS.  
 # 617, SEC 16-D,  
 CHAUDIGARH  
 PH. 771525.