

PROPOSED RESIDENTIAL COLONY : "ANMOL-CITY" ON BANUR-KHARAK ROAD AT BANUR, DISTT. PATIALA (PB.)

PROMOTERS:
TOP INDIAN PROMOTERS & COLONISERS, QUIET OFFICE NO-3, SEC-35, CHANDIGARH

TOTAL AREA OF THE SCHEME : 3.48 ACRES (16845.24 SQ.YDS.)
SCHEME OF BOUNDARY :

DETAIL OF RESIDENTIAL PLOTS:

S.No	PLOT NOS.	SIZE OF PLOT	AREA OF EACH PLOT IN SQ. YDS.	No. OF PLOTS.	TOTAL AREA OF PLOTS IN SQ. YDS.
1.	15-18, 25-30	30' X 60'	200.00	10	2,000.00
2.	20-24	32' X 60'	213.33	5	1,066.67
3.	11-14	30' X 65'	216.66	4	866.67
4.	19	30' X 39' X 60'	230.00	1	230.00
5.	9	23' 6" X 15' X 65'	139.02	1	139.02
6.	10	24' X 65'	173.33	1	173.33
7.	1-7, 2, 49-55	20' X 45'	100.00	14	1,400.00
8.	8 & 48	25' X 45'	125.00	2	250.00
9.	47	30' X 15' + 10' X 10'	155.55	1	155.55
10.	41-46 & 34-37	22' 6" X 55'	137.50	10	1,375.00
11.	31-33	33' 3" X 60'	221.67	3	665.00
12.	40	32' 6" + 40' X 22' 6"	90.62	1	90.62
13.	39	40' + 56' X 22' 6"	112.50	1	112.50
14.	38	22' 6" X 54'	135.00	1	135.00
			TOTAL	55	8659.36

	SQ. YDS.	ACRES	% AGE.
AREA UNDER RESIDENTIAL PLOTS :	8664.92	1.790	51.43
COMMERCIAL :	402.78	0.083	2.39
TOTAL SALEABLE :	9067.70	1.873	53.80
AREA UNDER WATER-WORKS :	171.53	0.0354	1.01
" " STP. :	312.01	0.0644	1.86
" " TOILET :	61.80	0.0127	0.37
" " PARK & GREEN :	988.47	0.2042	5.87
" " ROADS, PAVEMENTS & PARKING :	6243.73	1.290	37.09
TOTAL :	16,845.24	3.48	100.00

DETAIL OF PARKING:

AREA UNDER SHOPS: 402.78 SQ.YDS OR 337.21 SQ.M, F.A.R: 1:1.6 = 337.21 X 1.6 = 537.53 SQ.M.
CAR SPACE REQD: $\frac{537.53 \times 1.33}{100} = 7.17$ ECS, 1 ECS = 22 SQ.M, 7.17 X 22 = 157.74 SQ.M. 169.576 SQ.M.
CAR SPACE PROVIDED: 65' X 27' = 1755 SQ.FT.

WATER - SUPPLY & SEWERAGE NET- WORK.

- 10" φ SEWER PIPE
- 8" φ SEWER PIPE
- MAN HOLE
- 4" φ C.I. PIPE
- SLUICE VALVE
- FIRE HYDRANT.

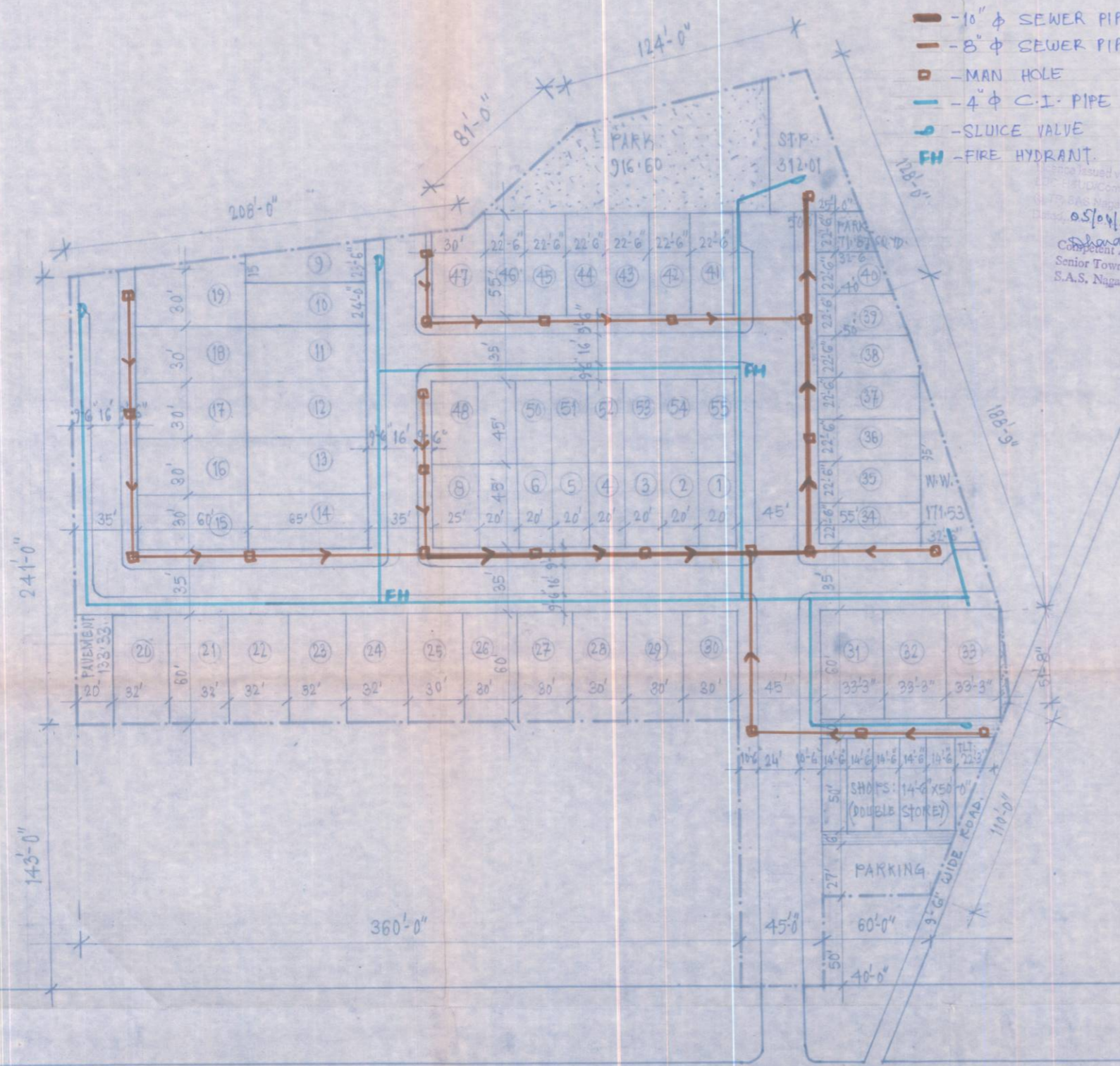

Competent Authority-cum Senior Town Planner S.A.S, Nagar

BANUR BANUR-KHARAK ROAD KHARAK

REVISED LAYOUT PLAN

DRG. NO. : 04CRW2 S
JOB NO : AC6
DATE : 8-3-06

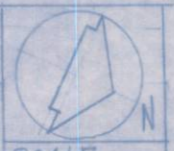

SCALE
1" = 40'-0"

For TOP INDIAN Promoters & Colonisers

Partner
Ar. G. Singh Dhillon
B.A., MCA, ALIA
Sector 35, Chandigarh

PROMOTER

ARCHITECT