

GOLDEN PUBLIC SCHOOL

GOLDEN FOREST AREA ROAD

(A)-ORGANISED GREEN AREA -PARKS(SQ.M)

1=(13.712M.X51.91M)X(57.18M.X12.698)=1437.86SQ.M.
 2=28.956M.X21.18M. =613.16SQ.M.
 3=(11.386M.X15.70M)X(29.91M.X2.52M.)
 +(21.433M.X20.122M) =685.469SQ.M.
 4=4.70M.X57.91M. =272.1817SQ.M.
 5=0.5X43.55M.X34.55M. =752.32SQ.M.
 6=0.5X23.43M.X18.40M. =215.556SQ.M.
 7=(61.92M.+62.88M)X(34.56M.+32.1M)=2081.976SQ.M.
 8=51.11M(X44.29M.+20.35M)-(14.2X11.2)=1450.44SQ.M.

TOTAL GREEN AREA = 7508.961 SQ.MT.

(B)-ORGANISED CLUSTER GREEN AREA(SQ.MT.)

F {6X726.87 (INTERNAL COURT OF A)}= 4,361.255
 G {1X444.00 (INTERNAL COURT OF B)}=444.0
 H {1X896.88 (INTERNAL COURT OF C)}=896.88
 I {1X279.54 (INTERNAL COURT OF D)}=279.54

TOTAL GREEN AREA = 6,878.553 SQ.MT.

GRAND TOTAL OF ORGANISED GREEN AREA(A+B) = 14,387.51 SQ.MT.(23.16%)

LAND USE TABLE

1. TOTAL AREA OF LAND = 61,120.34 SQ.MT.
 2. DISTRIBUTION OF AREA(SQ.MT.)

2.1 RESIDENTIAL - 19,527.96	(31.43%)	1/2 CENS 60 RS FLATS
2.2 COMMUNITY HA - 201.65	(0.320%)	
2.3 ROADS - 7,103.00	(11.82%)	
2.4 GREEN - 14,387.51	(23.60%)	
2.5 S.T.P. - 677.15	(1.09%)	
2.6 WATER WORKS -266.919	(0.428%)	
2.7 OPEN - 19,466.54	(31.32%)	

TOTAL LAND AREA AS PER KHASRA PLAN

73 BICHA - 14 BISWA

74,437.05 SQ.YRD

15.34 ACRES

61,120.34 SQ.MT.

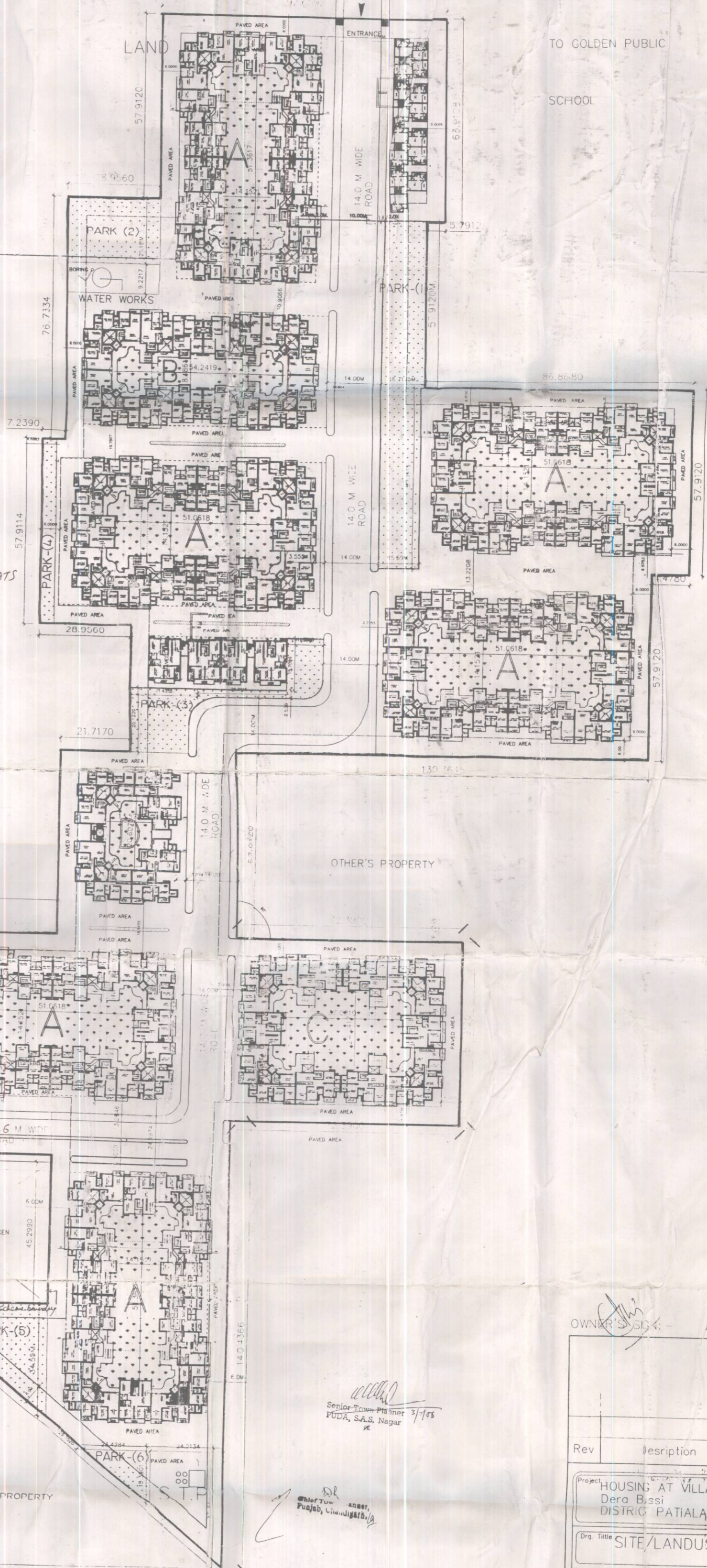

CHAMAN VATIKA SCHOOL
 200 Mts. TOWARDS AMBLA FROM THIS SITE

SPRING FIELD PUBLIC SCHOOL

Senior Town Planner
 PUDA, S.A.S. Nagar

Senior Town Planner
 PUDA, S.A.S. Nagar

OWNER'S SIGN: ARCHITECT'S SIGN:

Rev	Description	Date
		15-12-05

Project: HOUSING AT VILLAGE JHARMARI
 Dera Bissi
 DISTRICT PATIALA, PUNJAB

Dr. Title: SITE/LANDUSE PLAN

Client: OMAXE CONSTRUCTION LIMITED

Architects: DESIGN ACTION GROUP
 ARCHITECTS AND ENVIRONMENTAL PLANNERS
 2/7, JULIANA COMMERCIAL COMPLEX
 OKHRA ROAD, NEW DELHI -110025
 PH: 26912466, 26910496 FAX-26914133

Drawn: Chid. Comp. On: Scale: 1:600 Project No:
 Drg. No. OMAXE-03 Sheet: Rev. 1/1