

132

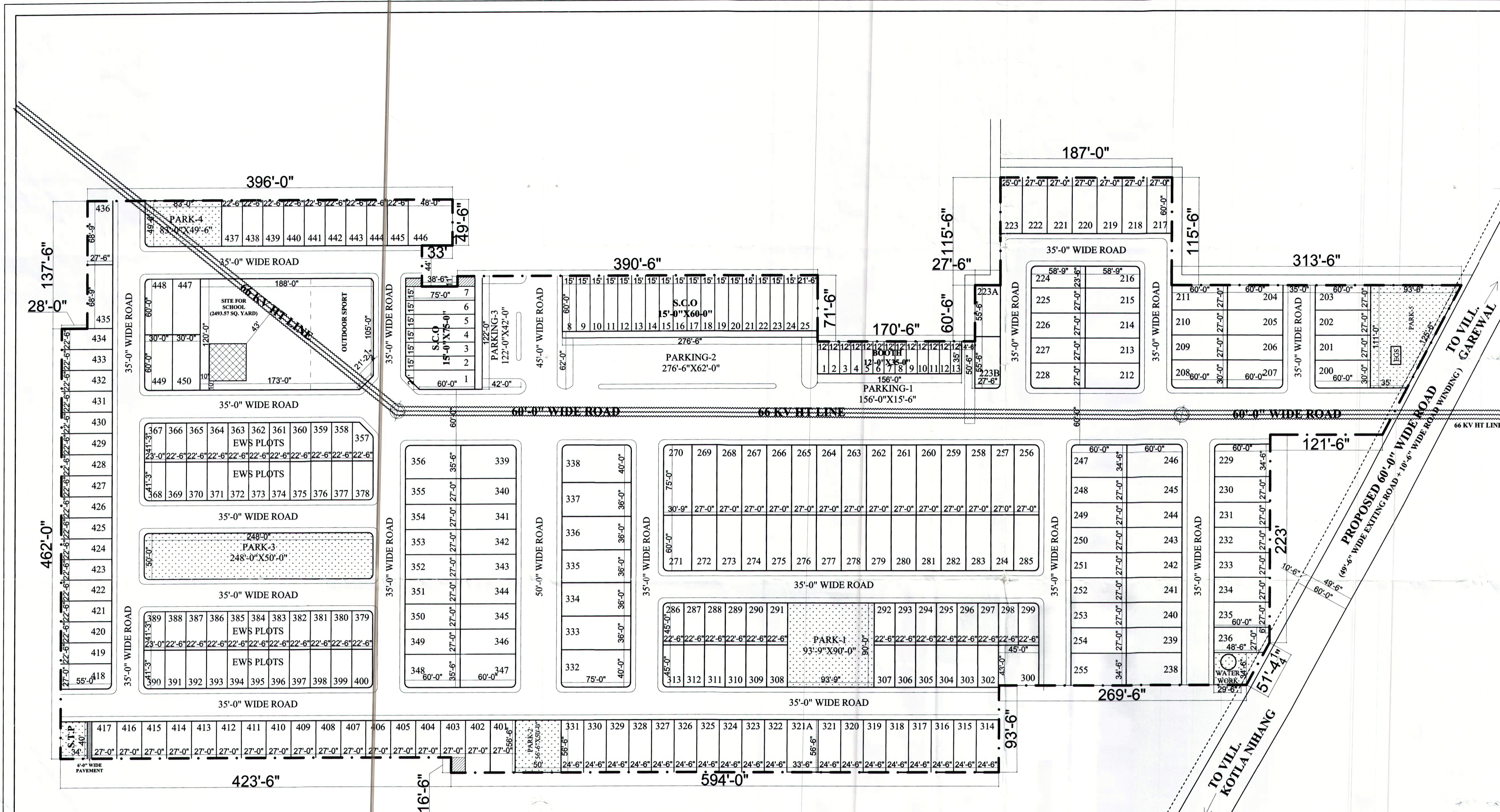

PROJECT
 PROPOSED LAYOUT PLAN FOR
 GOLDEN INFRASTRUCTURE PRIVATE LTD.
 NAMED AS "GOLDEN HOMZ"
 AT VILLAGE. KOTLA NIHANG, ROPAR
 DISTT. ROPAR, TEH. ROPAR (PUNJAB)

SITE AREA#	720046.8	SQ.FT.	80005.2	SQ.YDS.	16.53	ACRES
AREA UNDER RESIDENTIAL PLOTS:-						
SR. NO.	PLOT SIZE	PLOT AREA (IN SQ.FT.)	PLOT AREA (IN SQ.YDS.)	PLOT NOS	TOTAL NO OF PLOTS	TOTAL AREA (SQ.FT.)
1	30' X 60'	1800	200.00	200	1	1800
2	27' X 60'	1620	180.00	201-203	3	4860
3	27' X 60'	1620	180.00	204-205-209-211	6	9720
4	30' X 60'	1800	200.00	207	2	3600
5	27'-0" X 58'-9"	1566.25	176.25	212-215, 225-228	8	12690
6	25'-6" X 58'-9"	1380.625	153.40	216-224	2	2761.25
7	27'-0" X 60'-0"	1620	180.00	217-222	6	9720
8	25'-0" X 60'-0"	1500	166.67	223	1	1500
9	27'-6" X 55'-6"	1526.25	169.58	223A, 223B	2	3052.5
10	34'-6" X 60'-0"	2070	230.00	229	1	2070
11	27'-0" X 60'-0"	1620	180.00	230-235	6	9720
12	1500	166.67	236	1	1500	
13	34'-6" X 60'-0"	2070	230.00	236, 246, 247, 255	4	8280
14	27'-0" X 60'-0"	1620	180.00	239-245, 248-254	14	22680
15	27'-0" X 75'-0"	2025	225.00	256-259	4	8100
16	30'-9" X 75'-0"	2306.25	256.25	270	1	2306.25
17	30'-9" X 60'-0"	1845	205.00	271	1	1845
18	27'-0" X 60'-0"	1620	180.00	272-285	14	22680
19	22'-6" X 45'-0"	1012.5	112.50	286-289	4	4050
20	45'-0" X 43'	1935	215.00	300	1	1935
21	22'-6" X 45'-0"	1012.5	112.50	302-313	12	12150
22	24'-6" X 56'-6"	1384.25	153.81	314-331	18	24916.5
23	33'-6" X 56'-6"	1892.75	210.31	321A	1	1892.75
24	40'-0" X 75'-0"	3000	333.33	332-338	2	6000
25	36'-0" X 75'-0"	2700	300.00	333-337	5	13500
26	35'-6" X 60'-0"	2130	236.67	339-347, 348-356	4	8520
27	27'-0" X 60'-0"	1620	180.00	340-346, 349-355	14	22680
28	90.62	815.62	90.62	357	1	815.62
29	23' X 41'-3"	948.75	105.42	359-360	2	1897.5
30	27'-0" X 56'-6"	1525.5	169.50	401-402	2	3051
31	1335.72	148.41	403	1	1335.72	
32	27'-0" X 40'-0"	1080	120.00	404-417	14	15120
33	27'-0" X 55'-0"	1485	165.00	418	1	1485
34	22'-6" X 55'-0"	1237.5	137.50	419-434	16	19665
35	27'-6" X 68'-9"	1890.625	210.07	435-436	2	3781.25
36	22'-6" X 49'-6"	1113.75	123.75	437-445	9	10023.75
37	48'-0" X 49'-6"	2376	264.00	446	1	2376
38	30' X 60'	1800	200.00	447-450	4	7200
TOTAL					211	321790.09

SR. NO.	PLOT SIZE	PLOT AREA (IN SQ.FT.)	PLOT AREA (IN SQ.YDS.)	PLOT NOS	TOTAL NO OF PLOTS	TOTAL AREA (SQ.FT.)
39	22'-6" X 41'-3"	928.125	103.13	358-366, 369-378	19	17634.375
40	23' X 41'-3"	948.75	105.42	367-368	2	1897.5
41	22'-6" X 41'-3"	928.125	103.13	379-388, 391-400	20	18562.5
TOTAL					41	38094.375

SR. NO.	PLOT SIZE	PLOT AREA (IN SQ.FT.)	PLOT AREA (IN SQ.YDS.)	PLOT NOS	TOTAL NO OF PLOTS	TOTAL AREA (SQ.FT.)
1	SCO	1462.5	162.50	1	1	1462.5
2	SCO(15X75)	1125	125.00	2-5	5	5625
3	1125	125.00	7	1	1125	
4	SCO(15X60)	900	100.00	8-24	17	15300
5	SCO(21-6'X60)	1290	143.33	25	1	1290
6	800TH(12X3)	420	46.67	1	1	420
7	800TH(12X3)	420	46.67	2-13	12	5040
TOTAL					38	30282.5

TOTAL SALEABLE AREA 392037 54.18

SR. NO.	PLOT SIZE	PLOT AREA (IN SQ.FT.)	PLOT AREA (IN SQ.YDS.)	PLOT NOS	TOTAL NO OF PLOTS	TOTAL AREA (SQ.FT.)
1	PARK-1	8437.5	937.50	1	1	8437.5
2	PARK-2	2825	313.89	3	1	2825
3	PARK-3	1240	137.78	4	1	1240
4	PARK-4	4108.5	456.50	5	1	4108.5
5	PARK-5	8231.75	914.64	6	1	8231.75
TOTAL					5	38002.75

SR. NO.	PLOT SIZE	PLOT AREA (IN SQ.FT.)	PLOT AREA (IN SQ.YDS.)	PLOT NOS	TOTAL NO OF PLOTS	TOTAL AREA (SQ.FT.)
1	STP	1360	151.11	1	1	1360

SR. NO.	PLOT SIZE	PLOT AREA (IN SQ.FT.)	PLOT AREA (IN SQ.YDS.)	PLOT NOS	TOTAL NO OF PLOTS	TOTAL AREA (SQ.FT.)
1		1543.44	171.49	1	1	1543

SR. NO.	PLOT SIZE	PLOT AREA (IN SQ.FT.)	PLOT AREA (IN SQ.YDS.)	PLOT NOS	TOTAL NO OF PLOTS	TOTAL AREA (SQ.FT.)
1		22442.13	2493.57	1	1	22442.13

SR. NO.	PLOT SIZE	PLOT AREA (IN SQ.FT.)	PLOT AREA (IN SQ.YDS.)	PLOT NOS	TOTAL NO OF PLOTS	TOTAL AREA (SQ.FT.)
1		289456.97	29828.55	1	1	289456.97

TITLE: LAYOUT PLAN

SCALE: 1:64

DRG. NO. SUB-02

DEALT BY RAM PRAVESH SINGH

CHECKED BY

DATE 12-10-2011



LAYOUT PLAN

TOTAL COMMERCIAL AREA = 24802.5 + 5460 SFT.
FAR = (2 X 24802.5) + 5460 SFT. = 55065 SFT. = 5117.56 SQ. MTR.
PARKING REQUIRED :-
@100 SQ. MTR. = 2 ECS
= 5117.56/50 = 102.35 ECS SAY 102
OPEN PARKING :-
PARKING-1
= 156'-0" X 15'-6" + 14'-6" X 50'-6"
= 3150.25 SFT. = 292.77 SQ. MTR.
PARKING-2
= 276'-6" X 62'-0"
= 17143 SFT. = 1593.21 SQ. MTR.
PARKING-3
= 122'-0" X 42'-0"
= 5124 SFT. = 476.20 SQ. MTR.
TOTAL PARKING AREA
= PARKING -1 + PARKING -2 + PARKING -3
= 292.77 + 1593.21 + 476.20 = 2362.18 SQ. MTR.
@23 SQ. MTR. PER ECS
= 102.70 ECS SAY = 103 ECS

APPROVED
 VIDE LETTER NO. 565 STP (SI. 55-1)
 DATED 02-03-2012
 SENIOR TECHNICAL OFFICER
 S.A.S. NAGAR

Competent Authority

For Golden Infrastructure Pvt. Ltd.
 Managing Director

BATNAM SINGH
 CA/2011/51509
 Architect

OWNER

ARCHITECT

pioneer
 Design Group
 ARCHITECTURE, INTERIORS,
 TURNKEY FURNISHERS

Ar. R.P. SINGH

Office :- MIG 4513-C, SECTOR-70, Mohali.
 E-Mail :- ar.rampavesh.singh86@gmail.com
 Phone No. 0172-3053575
 Mb. No. 902394934

ARCHITECTS
 ENGINEERS
 PLANNERS
 INTERIOR
 DESIGNERS
 VALUERS